

# Fixing instructions

## STENI Colour, STENI Vision and STENI Nature

The facade panels are fixed as ventilated cladding on impregnated, wooden battens.

### Product information on pallet

The panels must be stored on pallets in a dry place, under cover and on firm level ground.

Documents, product information and fixing instructions are attached to the pallet.

STENI Colour and STENI Vision can be delivered in 3 different gloss levels. The pallet will be marked with the type of gloss level.

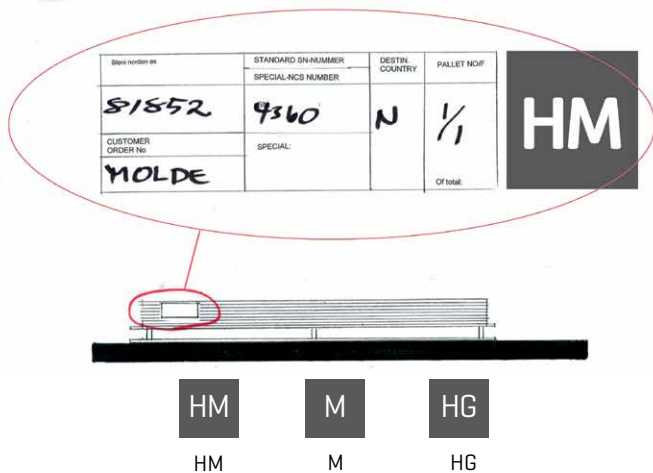

## FS100

Smooth fixing of facade panels on wooden battens

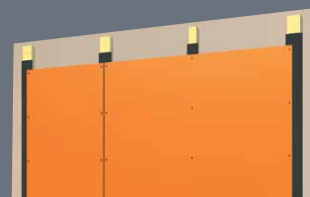

### Special documentation

#### Reaction to fire:

EN 13501-1, B-s1,d0

*STENI reserves the right to make changes/additions to the fixing instructions without further notice.*

### Control of measurements and tolerances

Make sure to control the measurements of the wall and panels before fixing. The panels have a tolerance of  $\pm 2$  mm, on width and length. Edge straightness of  $\pm 1$  mm, and a diagonal tolerance of max 3 mm.

Minor differences in measurements should be spread over several panels to achieve nice and even gaps between the panels.

Tolerance of drilling:  $\pm 5$  mm.

### Handling of panels

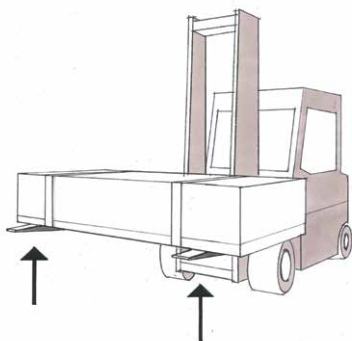

When transported on building site the pallets must always be strapped.

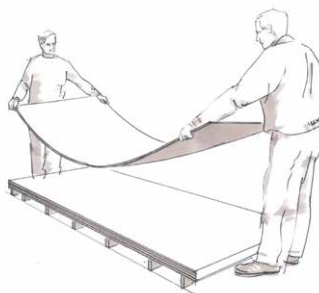

Lift the panels straight up from the pallets to avoid scratches.

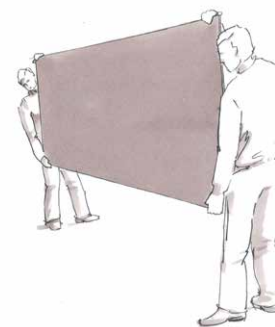

Carry the panels vertically.

### Wooden battens

The fixing of STENI facade panels are done as ventilated cladding on impregnated, wooden battens in accordance with Nordic standard AB [NS-INSTA 141]. Minimum quality C18 [18-20% RF]. It is important that the battens are levelled vertically and horizontally to ensure the best result.

#### Standard batten dimensions: [max dimension batten: 28 mm]

Underneath panel joint: 23 x 73 mm

Underneath centre of panel: 23 x 48 mm

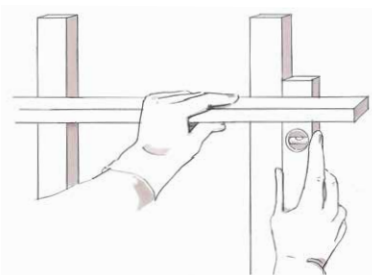

Steni-203-UK-01.16



LASTING EXPRESSIONS



# Fixing of STENI Nature

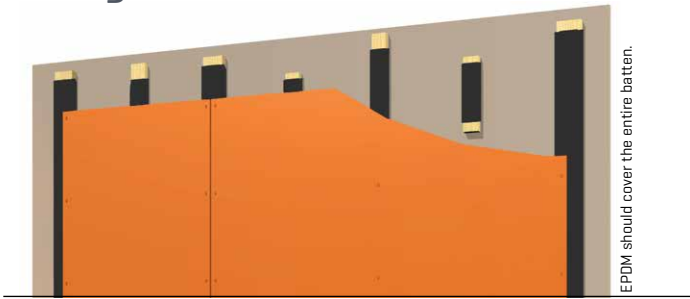

When fixing STENI Nature use an extra batten [c/c300] underneath all horizontal joints. Use at least one short batten, [see ill.], or use one whole batten. Half format (595 mm width) needs a full length batten as midsupport.

## Horizontal cross sections - vertical fixing:

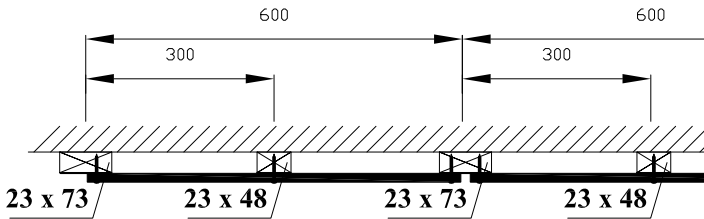

## Fixing advice

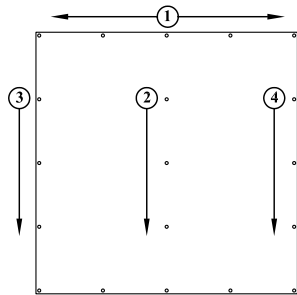

### Screw pattern

Use a measuring tool to set reference lines vertically and horizontally before starting the fixing of panels. The illustration shows a sample of screw pattern.

**Distance tool**  
When fixing with joint profile it is wise to use a distance tool.

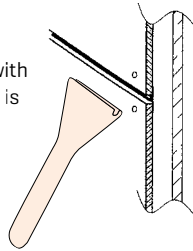

**"Vacuum tool for glass"**  
This makes handling of STENI panels easier.

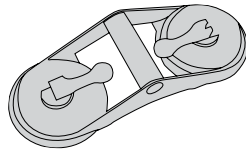

## Cutting and drilling

STENI Colour and STENI Vision is cut on the front side. Use straight edge. [Cutting disc 1]. Speed: min. 3000 r/min. STENI Nature is cut from the back side. [Cutting disc 2]. Drilling is done with a drill for tiles. Diameter of panel holes: 5,5 mm for STENI standard screw.

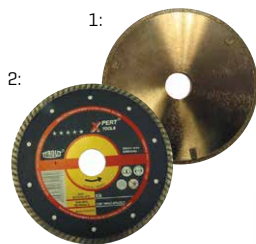

**NB!** Use protective equipment! See our documentation about health, environment and safety.

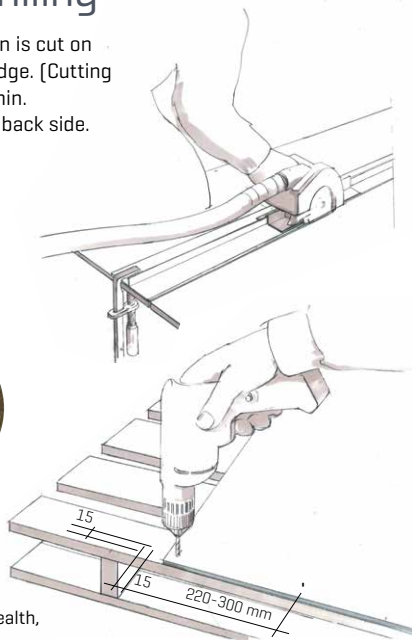

## Fixing with open joint



### Open joints:

Normally the panels are fixed with a 5 mm open joint, vertically and horizontally.

## Fixing with joint profiles

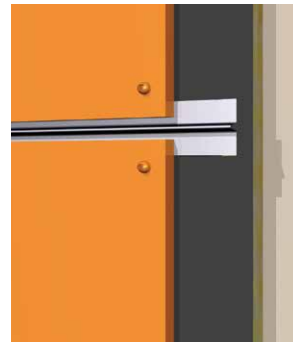

When using joint profiles use a distance of 8-10 mm. The panels must never be fixed edge-to-edge. Remember to fix the profiles with at least 5 mm open joints between each length.

1. Vertical profil: FP 6-30
2. Horizontal profil: HFP 7-30
3. Horizontal profil: HP 7-30

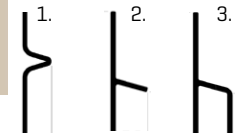

## Fixing with corner or u-element

### Corner element:

As corner solutions we recommend to use corner or corner profiles in order to ensure straight and nice solutions.

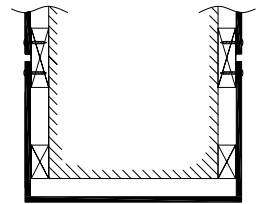
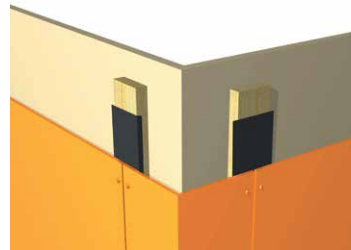

Outside corner with u-element.

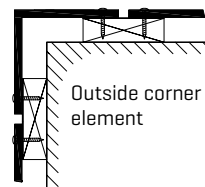

Outside corner element

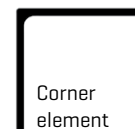

Corner element

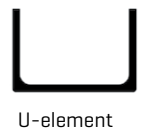

U-element

## Fixing with corner profile

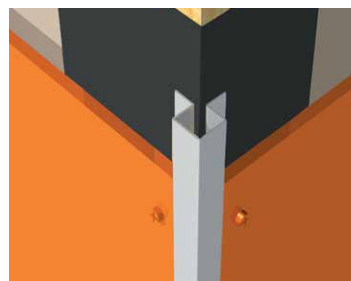

Remember to fix the profiles with at least 5 mm open joints between each length.



CP 15-13

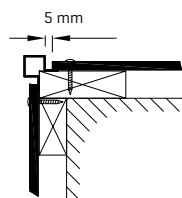

Corner with corner profile

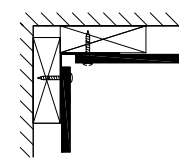

Inside corner

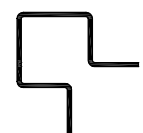

CP 15-18-33

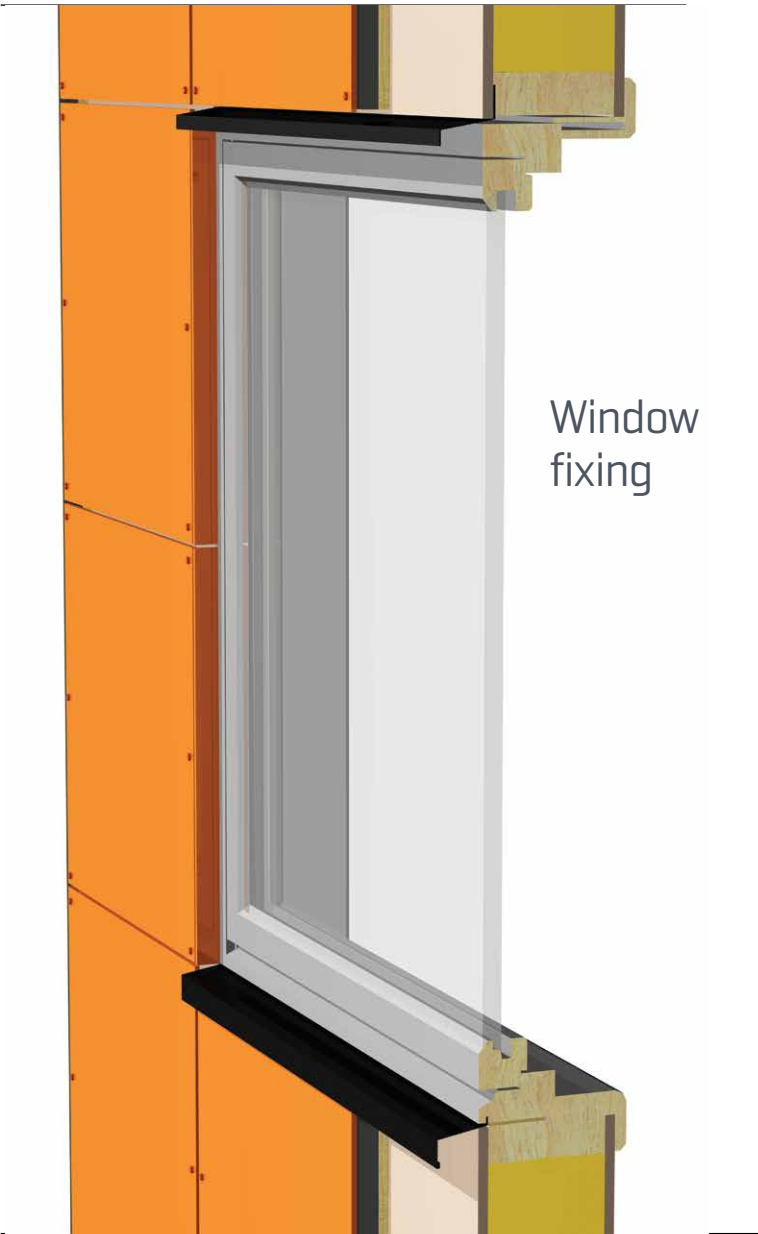

Window fixing

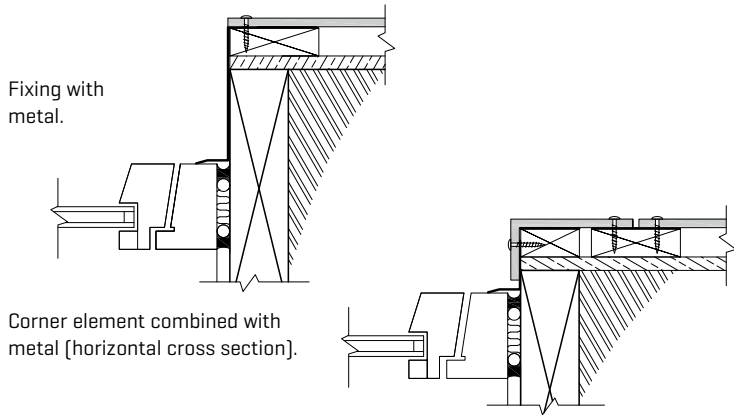

STENI facade panels fixed as ventilated cladding

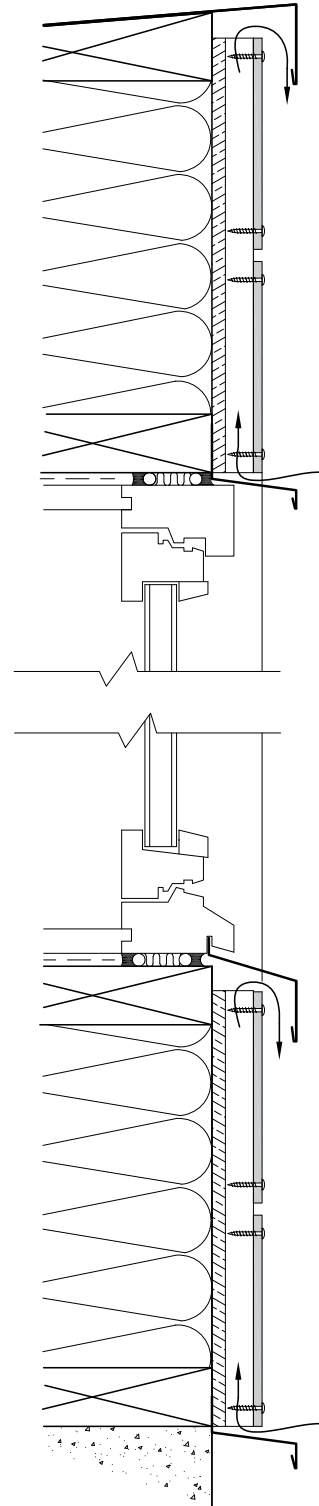

Steni-203-UK-01.16